

\$25 - 20 Thomlison Avenue, Red Deer

MLS® #A2028188

\$25

0 Bedroom, 0.00 Bathroom,
Commercial on 6.49 Acres

Timber Ridge, Red Deer, Alberta

Opportunity to pre-lease in Timber Ridge's newest commercial development, Timberlands Station. This plaza currently has four buildings in place with the plan to construct four more. Building J is currently under construction and pre-leasing with with 1,300-6,000 SF available. Ample parking is available on-site for customers and staff. Neighbouring businesses of the plaza include Tim Horton's, Pizza Hut, Fas Gas, and Pharmasave. Additional Rent is estimated at \$11.00 per square foot for the 2025 budget year.

Built in 2018

Essential Information

MLS® #	A2028188
Price	\$25
Bathrooms	0.00
Acres	6.49
Year Built	2018
Type	Commercial
Sub-Type	Retail
Status	Active

Community Information

Address	20 Thomlison Avenue
Subdivision	Timber Ridge
City	Red Deer
County	Red Deer
Province	Alberta

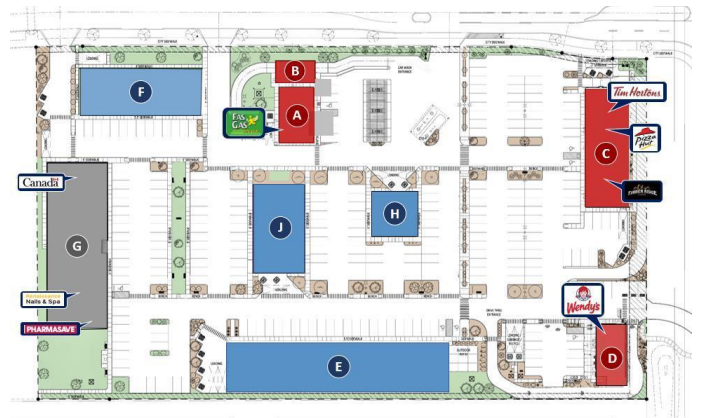

Postal Code T4P 3C7

Additional Information

Date Listed February 27th, 2023

Days on Market 770

Zoning C5

Listing Details

Listing Office RE/MAX Commercial Properties

Data is supplied by Pillar 9â„¢ MLSÂ® System. Pillar 9â„¢ is the owner of the copyright in its MLSÂ® System. Data is deemed reliable but is not guaranteed accurate by Pillar 9â„¢. The trademarks MLSÂ®, Multiple Listing ServiceÂ® and the associated logos are owned by The Canadian Real Estate Association (CREA) and identify the quality of services provided by real estate professionals who are members of CREA. Used under license.